

For Lease Groveland Center - Commercial Building 4059 Chelsea Rd W, Monticello 55362



PROPERTY INFORMATION

- * Lease Rate **\$15.00/psf Gross**
Plus Utilities
- * Building is 33,000/sf
Space Available: 2,891/sf
- * Wright County PID 155-141-001010
- * Zoned: B-3 Commercial Building
- * Multi-Tenant Building
- * Business in the Area Include:
Steele Collision, Enterprise Rent-A-Car,
Quarry Church, Dahlheimer Distributing,
Moon Motorsports and much more...



Contact:
SHEILA ZACHMAN
(763) 244-0600
SZachman@commrealtysolutions.com



COMMERCIAL REALTY SOLUTIONS

For Lease Groveland Center - Commercial Building 4059 Chelsea Rd W, Monticello 55362

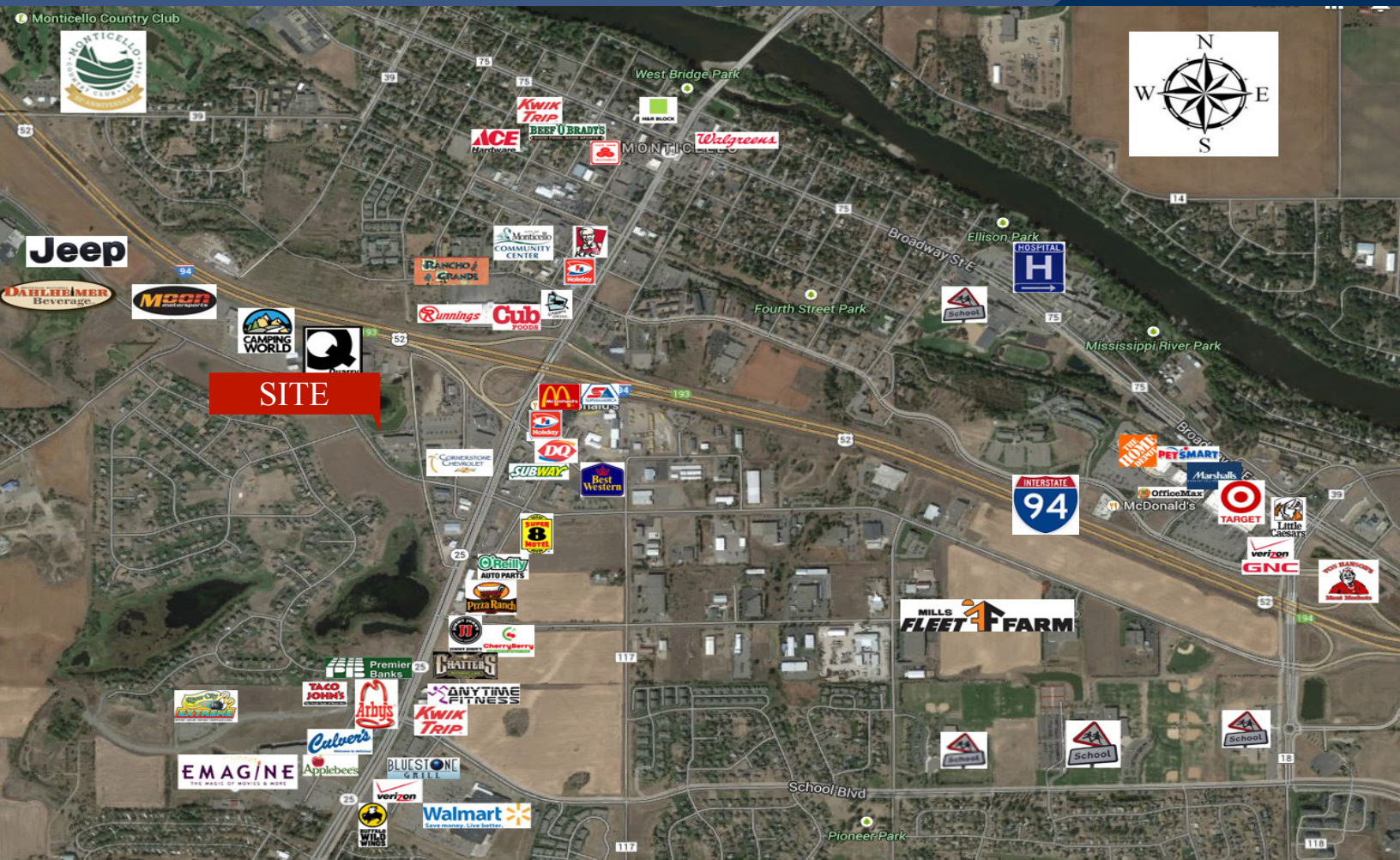

PROPERTY INFORMATION

- * West of Highway 25
- * South of I-94
- * Easy Access to Hwy & Interstate
- * Near Many Services
- * Located in Groveland Center

TRAFFIC COUNTS - 2018

- * Highway 25 - 27,500 VPD
- * Chelsea Road - 4,000 VPD

Contact:
SHEILA ZACHMAN
(763) 244-0600
SZachman@commrealtysolutions.com



COMMERCIAL REALTY SOLUTIONS

For Lease Groveland Center - Commercial Building 4059 Chelsea Rd W, Monticello 55362

PROPERTY INFORMATION

- * Current Tenant is Relocating
- * Current Use is Retail
- * Shared Restrooms



Floorplan



Contact:
SHEILA ZACHMAN
(763) 244-0600
SZachman@commrealtysolutions.com

For Lease
Groveland Center - Commercial Building
4059 Chelsea Rd W, Monticello 55362



Contact:
SHEILA ZACHMAN
(763) 244-0600
SZachman@commrealtysolutions.com