



Big Lake - Residential Development Land FOR SALE

20373 C.R. 81 NW, Big Lake, MN 55309

COMMERCIAL REALTY SOLUTIONS
www.commrealtysolutions.com



Easy Access
to
Highway 10!

PROPERTY INFORMATION

- * Sales Price **\$17,000.00**/per Acre
- * 92.51 Acres (Divisible)
- * Sherburne County PID: 10-324-2100 (32.84 Acres)
- * 2019 Taxes \$2,042.00
- * Sherburne County PID: 10-324-2400 (59.67 Acres)
(20 Acres Wooded)
- * 2019 Taxes \$1,458.00
- * Convenient to shopping and services
- * Minutes from Highway 10
- * Businesses in the area include:
Big Lake Auto, Russell's On The Lake,
McDonald's, U.S.P.S, Casey's, Family Dollar,
O'Reilly Auto Parts, Super America, Holiday
Station, and much more!

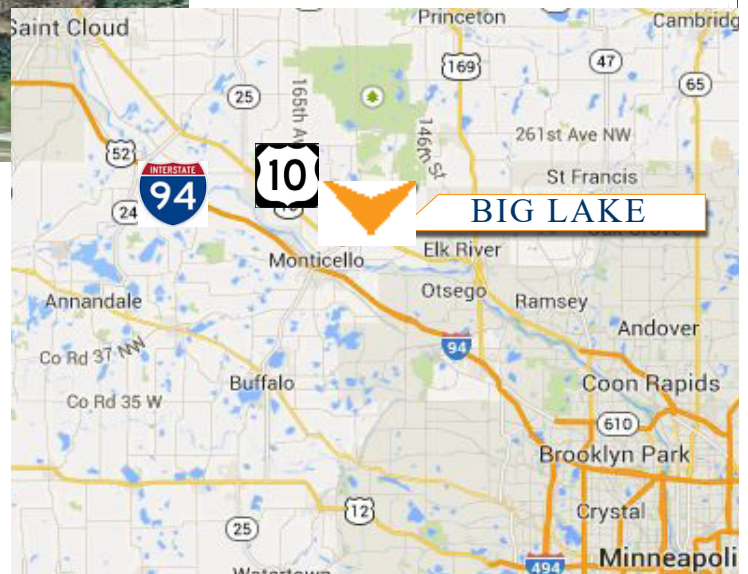

Contact:

WAYNE ELAM
(763) 229-4982

WElam@commrealtysolutions.com

3 Highway 55 West, Buffalo, MN 55313

office 763 682 2400 fax 763 682 4524

www.commrealtysolutions.com

Big Lake - Residential Development Land FOR SALE

20373 C.R. 81 NW, Big Lake, MN 55309

TRAFFIC COUNTS - 2018

- * Highway 10 - 13,400 VPD
- * County Road 81 - 4,000 VPD

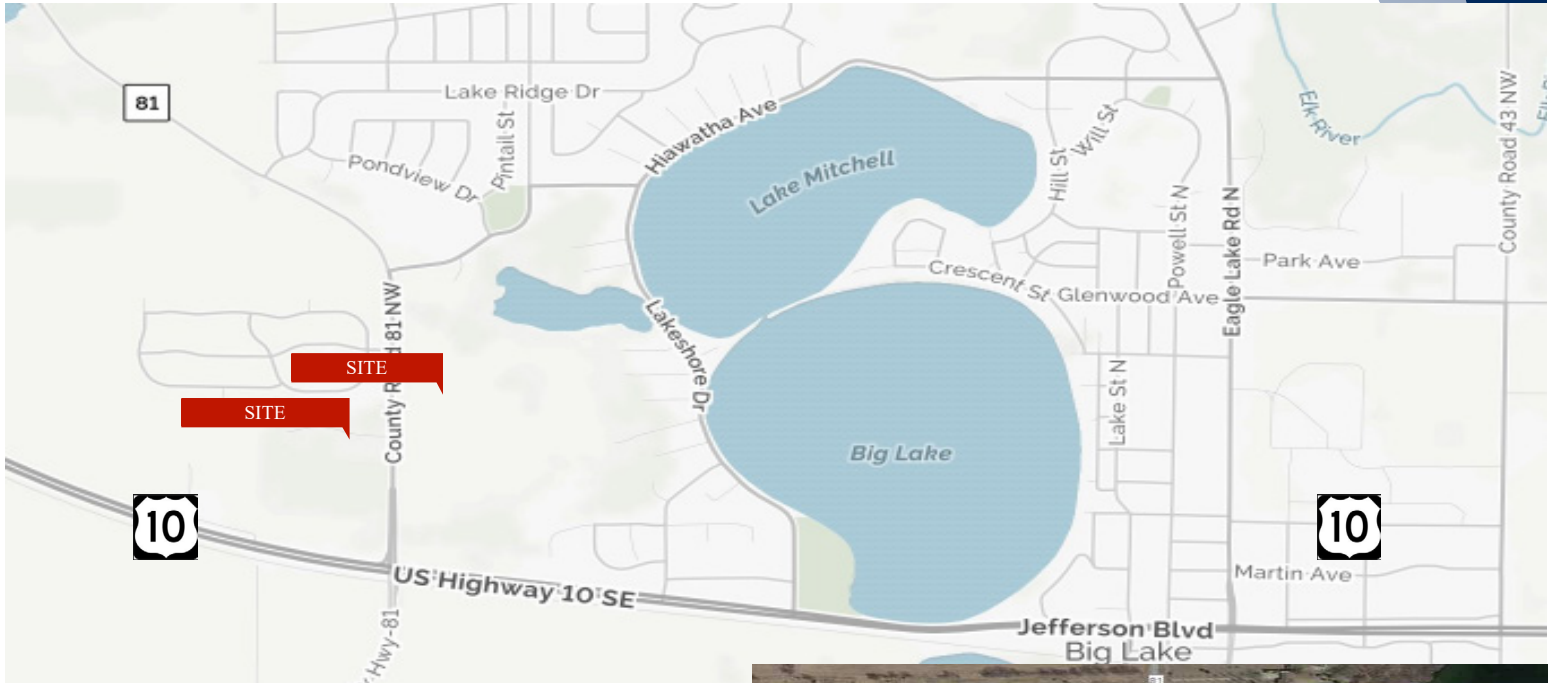

PROPERTY INFORMATION

- * North of Highway 10
- * East side of C.R. 81
- * Close to shopping and services!

Contact:

WAYNE ELAM
(763) 229-4982

WElam@commrealtysolutions.com



DEMOGRAPHICS 2015	1 Mile	3 Mile	5 Mile
Population	5,582	20,814	33,124
Median Age	39	41	40
Avg HH Inc.	\$ 49,873.00	\$ 57,223.00	\$ 56,884.00
Median HH Inc.	\$ 45,284.00	\$ 51,607.00	\$ 51,886.00



3 Highway 55 West, Buffalo, MN 55313

office 763 682 2400 fax 763 682 4524

www.commrealtysolutions.com